

# CAMPUS MAP BUILDING LEGEND

- |   |   |
|---|---|
| Art Buiding, 4                                | McCurry Commons, 22   |
| Business Building, 6                          | McCurry Hall, 24  |
| Casa del Sol Apartments, 10                   | Moffatt Hall, 25  |
| Challenge Course, 41                          | Music Building, 7   |
| Computing Services, 34                        | Nielsen Library, 29   |
| Conour Hall, 14                               | Old Art Building, 2   |
| Coronado-Housing Office/<br>Public Safety, 37 | Petteys Hall, 15  |
| Coronado Hall, 39                             | Plachy Hall, 31   |
| Crawford Softball Field, 42                   | Porter Hall, 16   |
| Education & Social Studies, 13                | President's House, 9  |
| Facility Services, 18                         | Rex Activity Center, 32   |
| Faculty Drive Apartments, 27                  | Rex Field, 30   |
| Faculty Residences, 28                        | Richardson Hall, 1  |
| Football Practice Field, 40                   | Savage Hall, 23   |
| Gingerbread House-Day Care, 20                | Soccer Fields, 19   |
| Girault Hall, 38                              | <u>Student Union Building/<br/>One Stop Student Services Center, 36</u> |
| Grizzly Courtyard, 33                         | Tennis Courts, 35   |
| Head Start, 21                                | Theatre, 3  |
| Houtchens Hall, 26                            | Valley Community Fund, 12   |
| KASF Radio Station, 11                        | Zacheis Observatory/Planetarium, 5                                      |
| Leon Memorial Auditorium, 8                   |   |

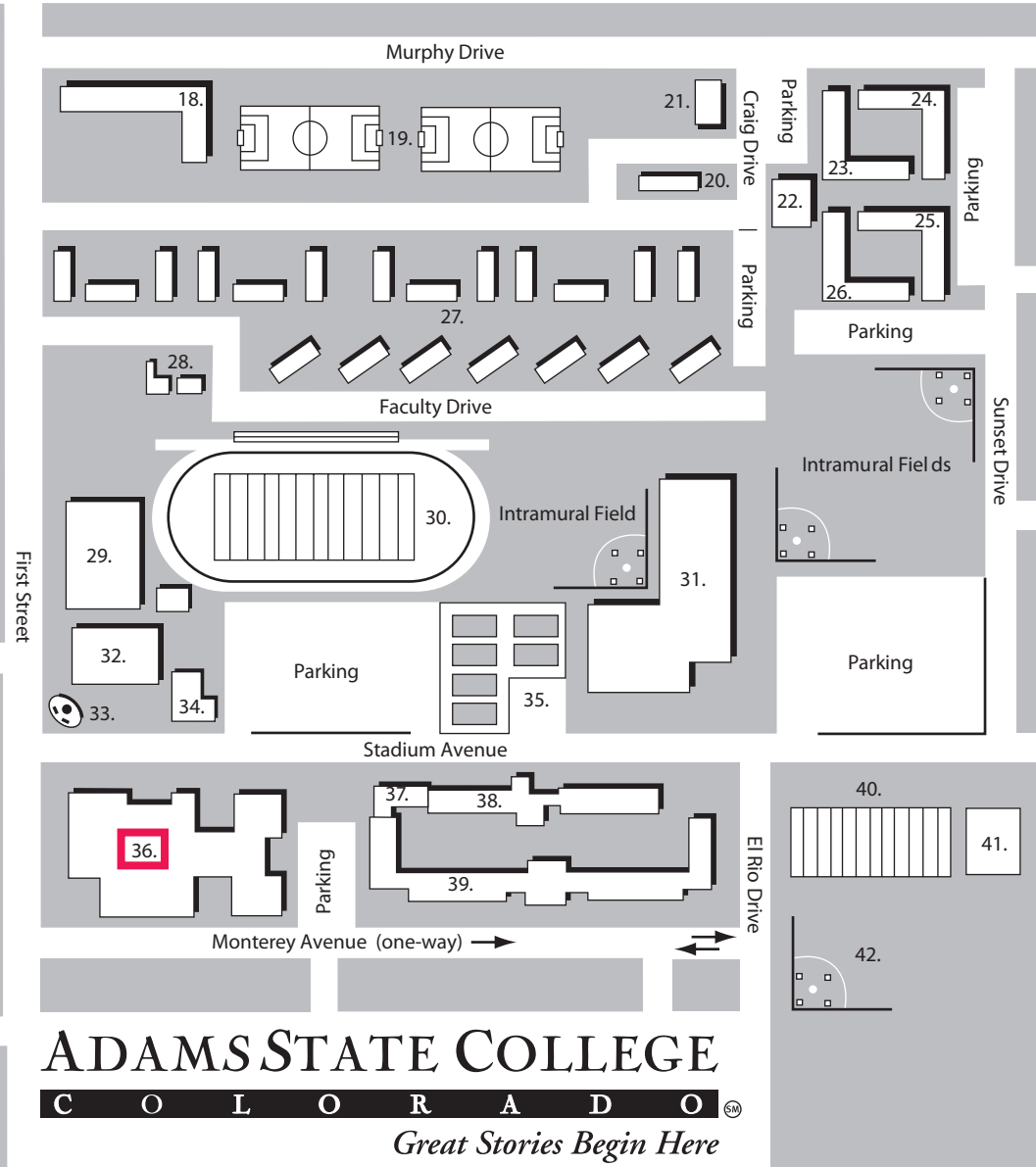
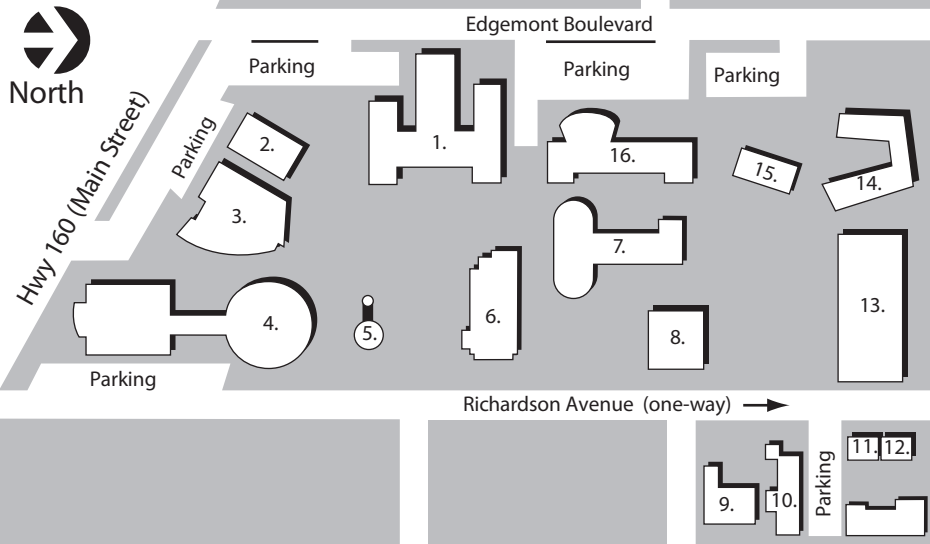

**ADAMS STATE COLLEGE**  
**C O L O R A D O** <sup>SM</sup>  
*Great Stories Begin Here*